



Camshaft Valve Timing Kit

Mercedes-Benz 1.8 | 2.1 | 2.2 CDI Diesel



Description

Specifically designed for the Mercedes-Benz vehicles fitted with the chain driven 1.8 | 2.1 CDI diesel engines (engine code pre fix 651).

The specially designed cam locking tool can be used on both early and late versions of the 651 Mercedes-Benz engine. These engines are found across the Mercedes-Benz range including as well as in the Jeep and Dodge ranges.

NOTE: 829120 supersedes Sonic Equipment kit 829087.

Plan Layout

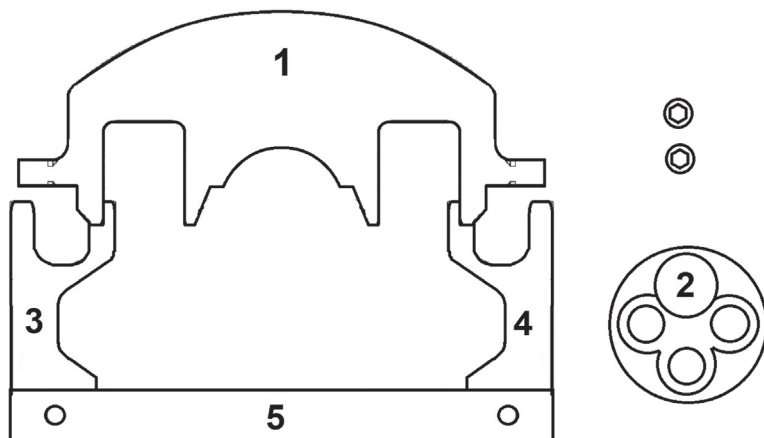

Ref	Code	OEM	Description
1	4880385	651 589 01 40 00 651 589 09 40 00 651589094000	Camshaft Locking Tool + Bolts
2	4880315	651 589 00 40 00	Crankshaft Pulley Holding Tool
3, 4, 5	4880314	651 589 02 63 00	Balance Shaft Locking Forks x 2 plus Locking Bar Assembly and Bolts



The following instructions are for guidance only. Please refer to OEM derived data such as the vehicle manufacturers' own data or Autodata.

The use of these engine timing tools is purely down to the user's discretion and Sonic Equipment cannot be held responsible for any damage caused what so ever.

Applications

Make	Model	Year	Type
Mercedes-Benz	E-Class Coupe/Cabriolet	2009-2017	BlueTEC Blue EFFICIENCY CDI 4Matic BlueTEC Hybrid 300H
	GLA	2014-2017	
	GLC	2015-2017	
	GLC Coupe	2016-2017	
	GLE	2015-2017	
	GLK	2008-2015	
	M-Class	2011-2016	
	S-Class	2010-2017	
	SLC	2016-2017	
	SLK	2012-2016	
	Sprinter	2009-2017	
	Valente	2015-2017	
	V-Class	2014-2017	
	Viano	2010-2014	
	Vito	2010-2016	
	A-Class	2012-2017	
	B-Class	2012-2017	
	C-Class	2009-2017	
	C-Class Cabriolet	2016-2017	
	C-Class Coupe	2011-2017	
	CLA Coupe	2013-2017	
	CLA Shooting Brake	2015-2017	
Jeep	CLS	2011-2017	
	E-Class	2009-2016	
	Compass	2011-2015	
	Patriot	2010-2013	

Engine Size	Engine Code
1.8	651.901
2.1	651.930, 651.921, 651.960, 651.913, 651.916, 651.912, 651.961, 651.980, 651.9, 651.956, 651.955, 651.957, 651.950, 651.940, 651.910, 651.911, 651.924, 651.925, 651.922, 651.911, 651.924
2.2	651.925, ENE (651.925)

Instructions

1. Always refer to manufacturer specific data and instructions.
2. Turn engine to TDC number one before disassembly of engine.

Component 1

Used to hold the camshafts in their timed positions as shown in Fig. 1.

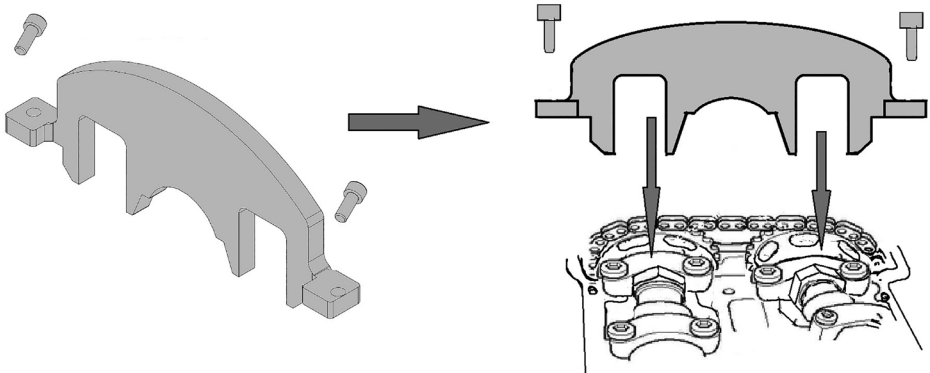

Component 2

Used to hold the crankshaft pulley and allow the pulley bolts to be loosened one at a time without turning the crankshaft as shown in Fig. 2a and 2b.

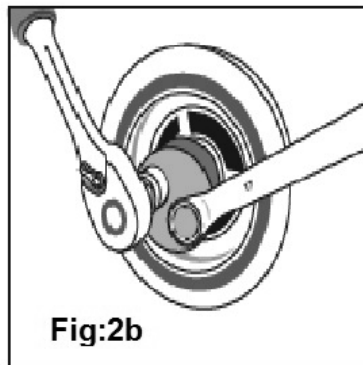
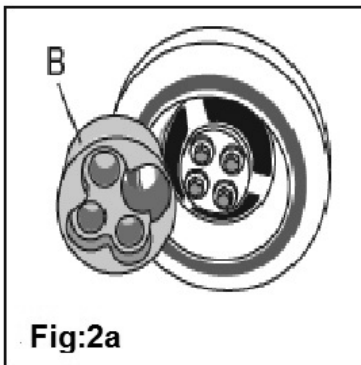

Instructions

Components 3, 4, 5

Used to lock the balance shafts in their timed position as shown in Fig. 3. Assemble 3, 4 and 5 as shown.

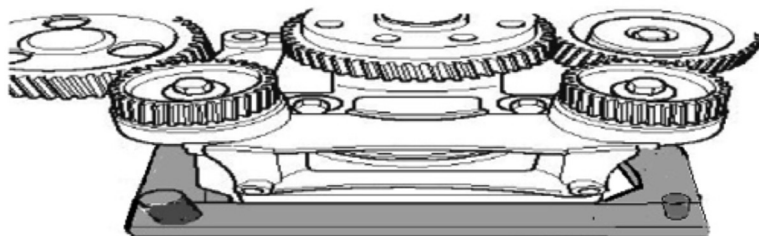

Our products are designed to be used correctly and with care for the purpose for which they are intended. No liability is accepted by Sonic Equipment for incorrect use of any of our products, and Sonic Equipment cannot be held responsible for any damage to personnel, property or equipment when using the tools. Incorrect use will also invalidate the warranty.

If applicable, the applications database and any instructional information provided has been designed to offer general guidance for a particular tool's use and while all attention is given to the accuracy of the data no project should be attempted without referring first to the manufacturer's technical documentation (workshop or instruction manual) or the use of a recognised authority such as Autodata.

It is our policy to continually improve our products and thus we reserve the right to alter specifications and components without prior notice. It is the responsibility of the user to ensure the suitability of the tools and information prior to their use.