

## Applications

Make	Model	Year	
Mercedes-Benz		190D	1983-1993
		190D Turbo	1986-1993
		190D	1986-1993
		200D	1984-1993
		200TD	1984-1993
		250D	1985-1993
		250D Turbo	1985-1993
		250TD	1985-1993
		208D	1988-1995
		210D	1988-1995
		308D	1988-1995
		310D	1988-1995
		408D	1988-1995
		410D	1988-1995
		508D	1989-1999
		812D	1989-1999
	C-Class	C200D	1989-1999
	E-Class	E200D	1989-1999
	E-Class	E290D Turbo	1989-1999
	Sprinter	208D	1995-2000
	Sprinter	209D	1995-2000
	Sprinter	308D	1995-2000
	Sprinter	408D	1995-2000
	Sprinter	POST	1995-2000
	Sprinter	210D	1995-2000
	Sprinter	212D	1995-2000
	Sprinter	310D	1995-2000
	Sprinter	312D	1995-2000
	Sprinter	410D	1995-2000
	Sprinter	412D	1995-2000
	Vario	512D	1995-2006
	Vario	612D	1995-2006
	Vario	812D	1995-2006
	V-Class	V230D Turbo	1996-2000
	Vito	108D	1996-2000
	Vito	110D	1996-2000
Jeep	Grand Cherokee		2001-2005

## Engine Code

2.0/2.3	601.911, 601.912, 601.940/941, 601.913, 601.943, 601.970, 601.942
2.5/2.9	602.911, 602.961, 602.912, 602.962, 602.940, 602.980, 602.982, 602.984, 602.985
2.7	2.7 CRD

Our products are designed to be used correctly and with care for the purpose for which they are intended. No liability is accepted by Sonic for incorrect use of any of our products, and Sonic cannot be held responsible for any damage to personnel, property or equipment when using the tools. Incorrect use will also invalidate the warranty.

If applicable, the applications database and any instructional information provided has been designed to offer general guidance for a particular tool's use and while all attention is given to the accuracy of the data no project should be attempted without referring first to the manufacturer's technical documentation (workshop or instruction manual) or the use of a recognised authority such as Autodata.

It is our policy to continually improve our products and thus we reserve the right to alter specifications and components without prior notice. It is the responsibility of the user to ensure the suitability of the tools and information prior to their use.

# sonic

equipment

## Instructions

## Engine Timing Kit

### Mercedes/Chrysler CRD - 2.2, 2.7



## 829086 - Engine Timing Kit

### Description:

The 829086 covers a large range of vehicles fitted with chain driven engines from Mercedes Benz including the PT Cruiser 2.2 CRD and Jeep Grand Cherokee 2.7 CRD from Chrysler.

### Components

Ref	Comp	OEM	Description
1	4880203	602 589 00 40 00 8929	Flywheel Locking Plate
2	4880206	602 589 00 40 00 8929	Camshaft Alignment Pins
3	4880205	601 589 02 40 00 8933	Flywheel Locking Plate
4			Bolts for 3

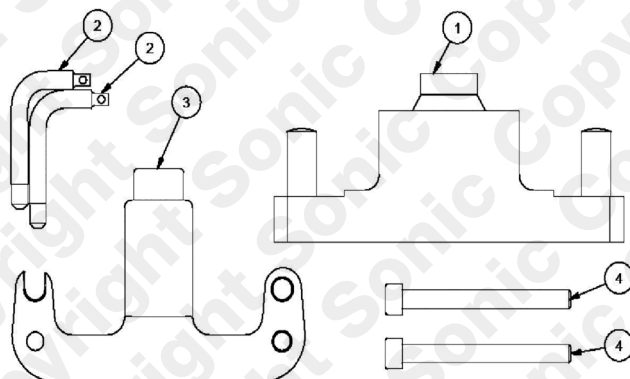

### Instructions

The following instructions are for guidance only. Please refer to OEM derived data such as the vehicles manufactures own data or Autodata. The use of these engine timing tools is purely down to the user's discretion and Sonic cannot be held responsible for any damage caused what so ever.

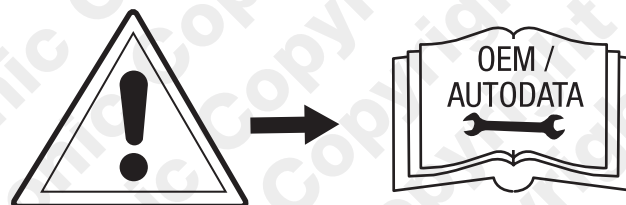

The camshaft locking pins included in this set are suitable for use on single, twin and quad camshaft applications.

On larger capacity quad cam engines the pins are located through appropriate holes in the back of the cam-box and then through the holes in the camshaft sprockets.

The flywheel locking tools 1 & 3 are usually fitted into the bell housing location points from where the starter motor has been removed and are necessary to prevent the flywheel from turning when releasing and re-tightening the crankshaft sprocket.

