

Applications

Make	Model	Year	Type
Saab	9-3	2004-2012	
	9-5	2005-2012	
Opel/Vauxhall	Astra-H	2004-2011	TD TTiD X TTiD CDTi CDTi VCDi Bi-CDTi ecccFLEX
	Signum	2004-2008	
	Vectra-C	2004-2008	
	Zafira-B/Zafira Family	2005-2012	
	Insignia / Country Tourer	2008-2015	
	Zafira-C Tourer	2011-2015	
	Malibu	2012-2015	
	Astra / Asrta J	2009-2013	
	Cascada	2013-2015	

Engine Code

1.9	Z19DT, Z19DTH, Z19DTR, Z19DTJ, Z19DTL, A19DTR
2.0	LBQ/A20DTL, LBR/A20DT, LBS/A20DTH, LBS, LBX/A20DTJ, LBY/A20DTR, LCD/A20DTC

Our products are designed to be used correctly and with care for the purpose for which they are intended. No liability is accepted by Sonic for incorrect use of any of our products, and Sonic cannot be held responsible for any damage to personnel, property or equipment when using the tools. Incorrect use will also invalidate the warranty.

If applicable, the applications database and any instructional information provided has been designed to offer general guidance for a particular tool's use and while all attention is given to the accuracy of the data no project should be attempted without referring first to the manufacturer's technical documentation (workshop or instruction manual) or the use of a recognised authority such as Autodata.

It is our policy to continually improve our products and thus we reserve the right to alter specifications and components without prior notice. It is the responsibility of the user to ensure the suitability of the tools and information prior to their use.



Instructions

Engine Timing kit  
Opel, Renault, Saab Diesel DOHC CDTi -  
1.9

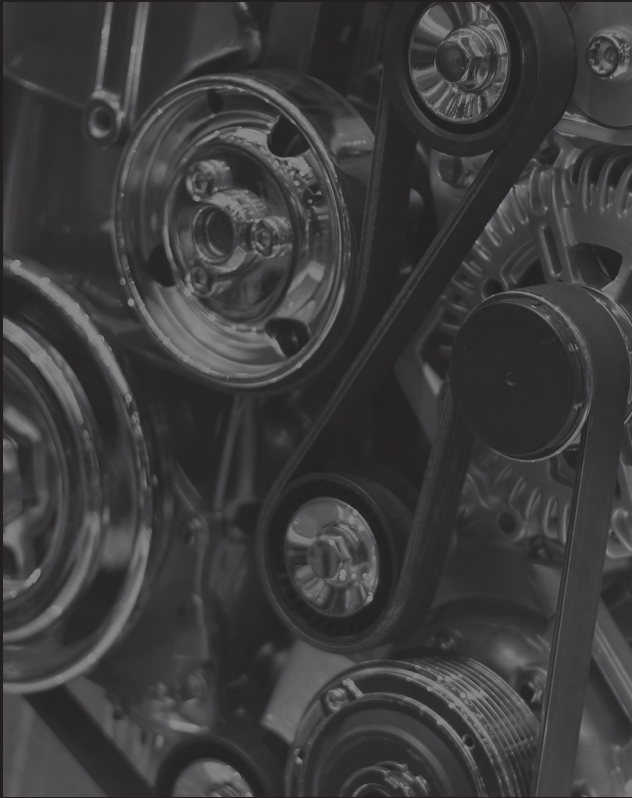

## 829062 - Engine Timing kit

### Description:

The 829062 provides the essential tools required to replace the camshaft drive belt and remove the camshafts on the Vauxhall/Opel CDTi 1.9/2.0lt twin cam diesel engines listed below.

### Components

Ref	Comp	OEM	Description
1	4880137	EN-46788	Stud Assembly use with 3
2	4880185	KM-6130, 6349	Auxiliary Drive Belt Tensioner Locking Pin (4 x 55)
3	4880187	EN-46788/1, 32 025 009	Crankshaft Alignment Tool
4	4880188	EN-46789, 32 025 008	Camshaft Alignment Tool x2
5	4880189	EN-46789-100	Camshaft Setting Pin Assembly.
6	4880332	SSM6x20B	M8 x 20 H.T. Screw use with 3

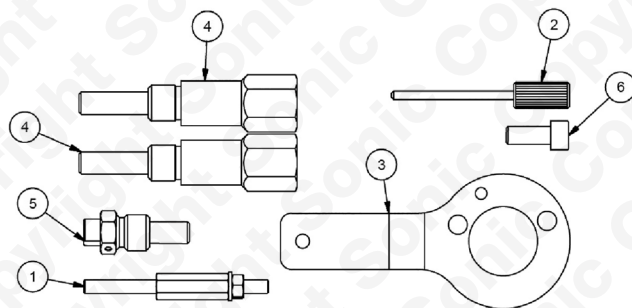

### Instructions

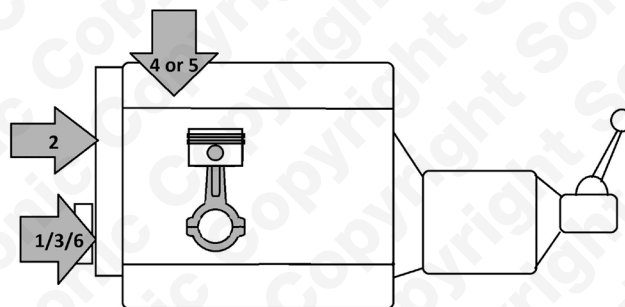

Component 1,3 & 6 - Crankshaft Alignment Tool

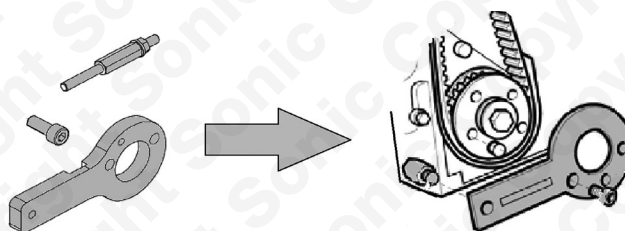

Component 2 - Auxiliary Drive Belt Tensioner Locking Pin (4 x 55).

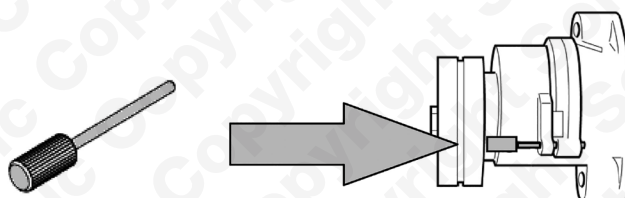

### Component 4 or 5 - Camshaft Alignment Tool x2

If removing camshaft drive gears, time the camshafts with components 4.  
If replacing belt only, use component 5 to lock the Exhaust cam only.

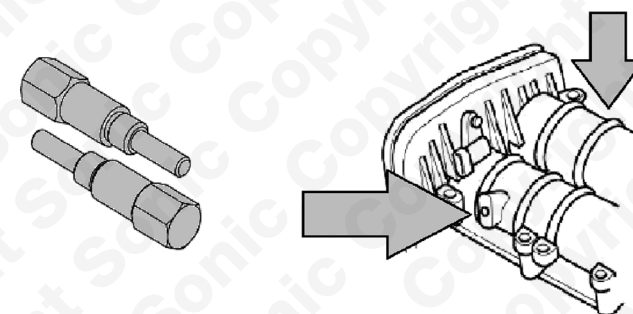

### Instructions

The following instructions are for guidance only. Please refer to OEM derived data such as the vehicles manufactures own data or Autodata. The use of these engine timing tools is purely down to the user's discretion and Sonic cannot be held responsible for any damage caused what so ever.

