



## 829058 - Engine Timing kit

### Description:

The 829058 has been specifically put together to allow the user to lock the engine components of the 1.4, 1.6, 1.8 and 2.0 16V Turbo and non-turbo petrol engines.

## Components

Ref	Comp	OEM	Description
1	4880048	MOT 1489	Crankshaft Locking Pin
2	4880095	MOT 1054	Crankshaft Locking Pin
3	4880109	MOT 1496	Camshaft Setting Bar - Renault
4	4880111	MOT 1750	Mounting Bracket for 3
5	4880115	MOT 1490	Camshaft Pulley Alignment Tool - Renault
6	4880117	MOT 1801	Camshaft Sprocket Locking Tool - Renault 2.0 (Eng. F4R)
7	4880323	MOT 1368	Cam-belt Tensioning Tool (3894)

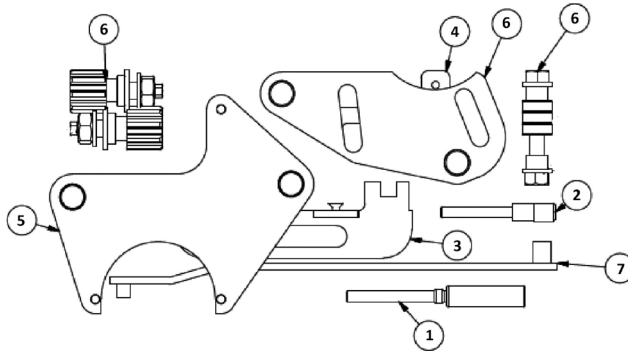

## Instructions

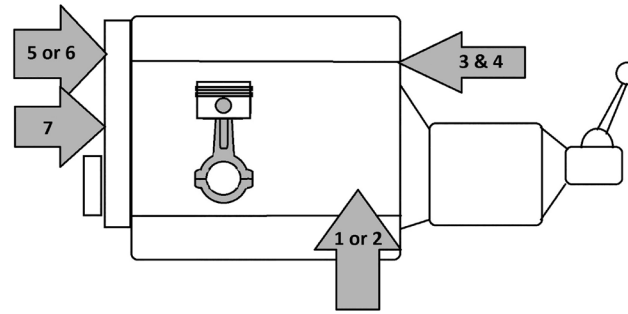

Component 3 & 4 - Camshaft Setting Bar - Renault  
Used to lock the camshafts independently of the camshaft pulleys.

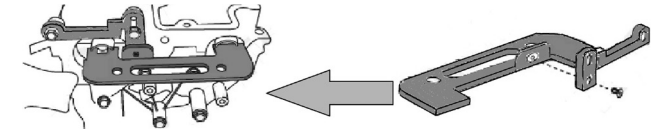

Component 5 & 6 - Camshaft Pulley Alignment Tool - Renault  
5 - Use to lock the camshaft pulleys (except F4Rb engines).  
6 - used to lock the camshaft pulleys (F4R engines only)

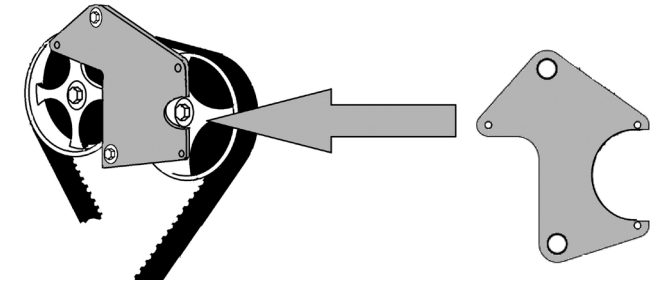

Components 1 & 2 - Crankshaft Locking Pins  
Component 1 - 1.4 & 1.6 engines  
Component 2 - 1.8 and 2.0 engines

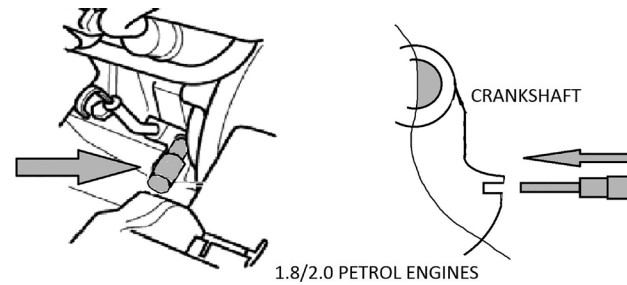
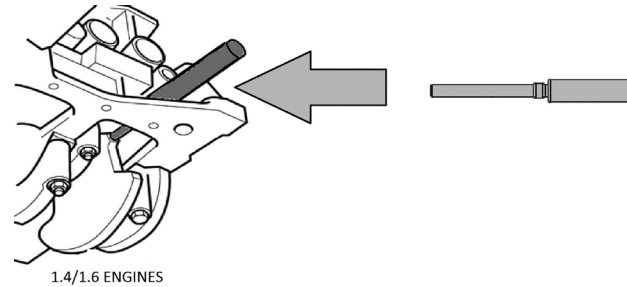

Component 7 = Cam-belt Tensioning Tool  
5 - Use to adjust the belt tensioner.

## Instructions

The following instructions are for guidance only. Please refer to OEM derived data such as the vehicles manufactures own data or Autodata. The use of these engine timing tools is purely down to the user's discretion and Sonic cannot be held responsible for any damage caused what so ever.

