

Applications

| Make | Model | Year |
|----------|-------------------------|-----------|
| Renault | Avantime | 2000-2003 |
| | Clio II | 1998-2010 |
| | Clio III | 2005-2013 |
| | Espace III | 1998-2003 |
| | Espace IV | 2002-2010 |
| | Kangoo | 2001-2008 |
| | Kangoo II | 2008-2013 |
| | Laguna | 1998-2001 |
| | Laguna II | 2001-2007 |
| | Laguna III | 2007-2013 |
| | Megane/Megane Scenic | 1999-2003 |
| | Megane II | 2002-2009 |
| | Megane III | 2008-2013 |
| | Modus | 2004-2008 |
| | Modus/Grand Modus II | 2008-2013 |
| | Scenic | 1999-2003 |
| | Scenic/Grand Scenic II | 2002-2009 |
| | Scenic/Grand Scenic III | 2009-2013 |
| Dacia | Trafic II | 2001-2011 |
| | Twingo II | 2007-2014 |
| | Vel Satis | 2000-2010 |
| Nissan | Wind | 2010-2014 |
| | Duster | 2010-2014 |
| | Logan/Logan MCV | 2005-2013 |
| Vauxhall | Sandero | 2008-2013 |
| | Kubistar | 2003-2009 |
| | Primastar | 2002-2011 |
| Vauxhall | Vivaro | 2002-2011 |

Engine Code

| | |
|-----|--|
| 1.4 | K4J 700, K4J 710, K4J 711, K4J 712, K4J 713, K4J 714, K4J 715, K4J 730, K4J 732, K4J 740, K4J 750, K4J 770, K4J 780 |
| 1.6 | K4M 606, K4M 616, K4M 690, K4M 690, K4M 696, K4M 697, K4M 700, K4M 701, K4M 704, K4M 706, K4M 708, K4M 709, K4M 710, K4M 711, K4M 712, K4M 714, K4M 716, K4M 718, K4M 720, K4M 724, K4M 730, K4M 732, K4M 734, K4M 736, K4M 740, K4M 742, K4M 743, K4M 744, K4M 745, K4M 746, K4M 748, K4M 750, K4M 752, K4M 753, K4M 760, K4M 761, K4M 764, K4M 766, K4M 776, K4M 782, K4M 790, K4M 791, K4M 792, K4M 794, K4M 800, K4M 801, K4M 802, K4M 804, K4M 812, K4M 813, K4M 824, K4M 830, K4M 831, K4M 834, K4M 846, K4M 848, K4M 854, K4M 858, K4M 862, K4M 866 |
| 1.8 | F4P 720, F4P 722, F4P 760, F4P 770, F4P 771, F4P 772, F4P 773, F4P 774, F4P 775 |
| 2.0 | F4R 700, F4R 701, F4R 712, F4R 713, F4R 714, F4R 715, F4R 720, F4R 722, F4R 730, F4R 732, F4R 740, F4R 741, F4R 744, F4R 746, F4R 770, F4R 771, F4R 780, F4R 790, F4R 791, F4R 792, F4R 820, F4R 830, F4R 832, F4R 720, F4R 722, F4R 762, F4R 763, F4R 764, F4R 765, F4R 766, F4R 767, F4R 776, F4R 776, F4R 784, F4R 786, F4R 787, F4R 794, F4R 795, F4R 796, F4R 797, F4R 800, F4R 802, F4R 810, F4R 811, F4R 813, F4R 820, F4R 820, F4R 867, F4R 870, F4R 872, F4R 874, F4R 886, F4R 887, F4R 896, F4R 897 |

Our products are designed to be used correctly and with care for the purpose for which they are intended. No liability is accepted by Sonic for incorrect use of any of our products, and Sonic cannot be held responsible for any damage to personnel, property or equipment when using the tools. Incorrect use will also invalidate the warranty.

If applicable, the applications database and any instructional information provided has been designed to offer general guidance for a particular tool's use and while all attention is given to the accuracy of the data no project should be attempted without referring first to the manufacturer's technical documentation (workshop or instruction manual) or the use of a recognised authority such as Autodata.

It is our policy to continually improve our products and thus we reserve the right to alter specifications and components without prior notice. It is the responsibility of the user to ensure the suitability of the tools and information prior to their use.

sonic

equipment

Instructions

Engine Timing kit

Renault/Nissan Petrol (K4) - 1.6, 2.0



829054 - Engine Timing kit

Description:

The 829054 offers the essential engine timing tools required for the Renault petrol 16v belt driven 1.6L and 2.0L engines. The 829054 kit of four tools enables the correct engine timing to be performed on Renault K4J, K4M & F4P, F4R engines, when changing the timing belt. The set includes 2 crankshaft timing pins and camshaft setting bar with the bracket specifically for the K4M 813 engine from 2003 onwards.

Components

| Ref | Comp | OEM | Description |
|-----|---------|----------|--------------------------------|
| 1 | 4880048 | MOT 1489 | 1.4/1.6 Crankshaft Locking Pin |
| 2 | 4880095 | MOT 1054 | 1.8/2.0 Crankshaft Locking Pin |
| 3 | 4880109 | MOT 1496 | Camshaft Setting Plate |
| 4 | 4880111 | MOT 1750 | Camshaft Setting Plate Bracket |

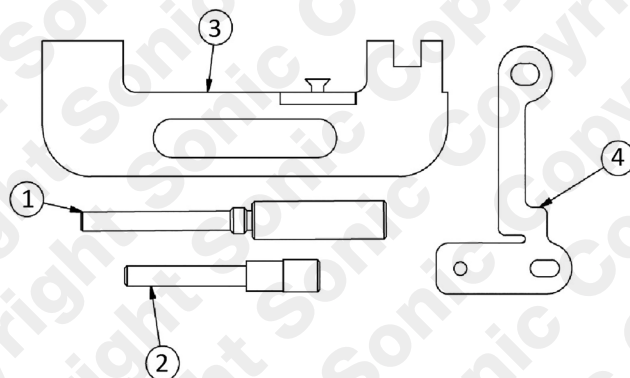

Instructions

1.4/1.6 ENGINES

Crankshaft Locking PIN (1) use component 1 to set the alignment of the crankshaft on 1.4L & 1.6L engines.

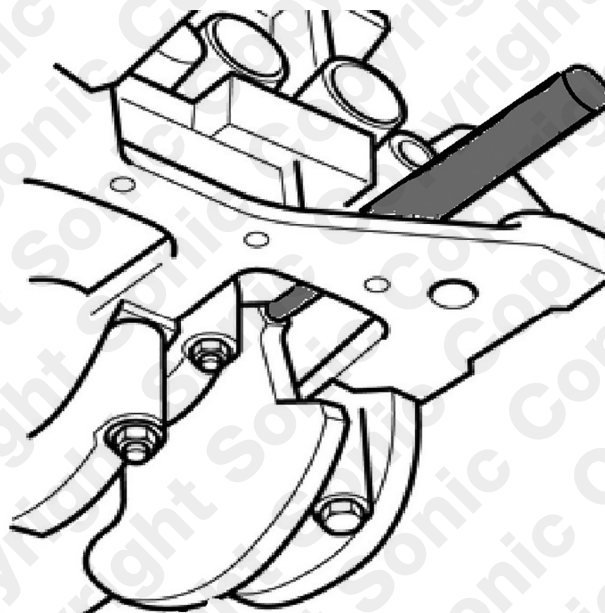

1.8/2.0 ENGINES

Crankshaft locking PIN (2) use component 2 to set the alignment of the crankshaft on the 1.8L & 2.0L engines. Ensure the pin engages in to the slot in the crankshaft counter weight.

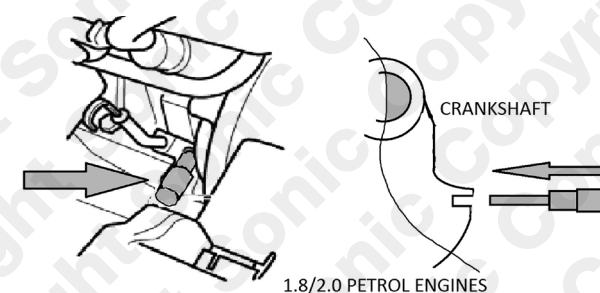

Camshaft Setting Plate & Bracket (3 & 4) use components 3 & 4 to set the alignment of the camshaft as shown.

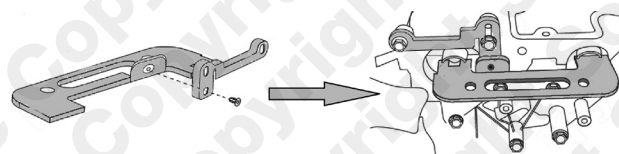

Instructions

The following instructions are for guidance only. Please refer to OEM derived data such as the vehicles manufactures own data or Autodata. The use of these engine timing tools is purely down to the user's discretion and Sonic cannot be held responsible for any damage caused what so ever.

