

Applications

Make	Model	Year	
Ford	B-Max	2012-2016	EcoBoost Zetec S Red/Black Edition SCTi EcoBoost SCTi EcoBoost ECOnetic EcoBoost ECOnetic
	C-Max	2012-2016	
	EcoSport	2013-2016	
	Fiesta	2013-2016	
	Focus	2012-2016	
	Grand C-MAX	2012-2016	
	Grand Tourneo Connect	2013-2016	
	Mondeo	2015-2016	
	Tourneo Connect	2013-2016	
	Tourneo Courier	2014-2016	

Engine Code	
1.0	M1JA, M1JE, M1JH, SFJA, SFJB, SFJC, SFJD, M1DA, M2DA, M1DD, M2DC, M1JC, M1JJ, P4JA, P4JB, P4JC, P4JD, XMJB, XMJC, XMJD, YYJB, YYJA, M2DB, SFDB, M2GA, M2GB, M1CA, M1CB, SFCA, SFCB, SFCC, SFCD, XMJA

Our products are designed to be used correctly and with care for the purpose for which they are intended. No liability is accepted by Sonic for incorrect use of any of our products, and Sonic cannot be held responsible for any damage to personnel, property or equipment when using the tools. Incorrect use will also invalidate the warranty.

If applicable, the applications database and any instructional information provided has been designed to offer general guidance for a particular tool's use and while all attention is given to the accuracy of the data no project should be attempted without referring first to the manufacturer's technical documentation (workshop or instruction manual) or the use of a recognised authority such as Autodata.

It is our policy to continually improve our products and thus we reserve the right to alter specifications and components without prior notice. It is the responsibility of the user to ensure the suitability of the tools and information prior to their use.



Instructions

Engine Timing Kit  
Ford Petrol Gtdi Ecoboost -1.0



## 829051 - Engine Timing Kit

### Description:

Specifically designed for the new Ford 1.0lt 3 cylinder EcoBoost engines. The 829051 kit offers the timing tools required for replacement of the oil bathed camshaft drive belt on these engines.

NOTE: WHERE THE VCT PULLEYS REQUIRE REMOVING OR SETTING THE ADDITIONAL KIT PART NUMBER 829050 WILL BE REQUIRED.

## Components

Ref	Comp	OEM	Description
1	4880253	303-1604	Crankshaft timing pin
2	4880254	303-1602	Flywheel holding tool
3	4880274	303-1054	3mm Cam-belt tensioner locking pin
4	4880096	8mm tensioner pin	Auxiliary belt tensioner pin EcoSport only
5	4880242	303-1605/1	INLET camshaft alignment tool
6	4880243	303-1606/2	EXHAUST camshaft alignment tool
7	4880238	303-1603	Crankshaft oil seal installer
8	4880121	4mm tensioner pin	Auxiliary belt tensioner pin except EcoSport
9	4880084	303-732	5mm crankshaft pulley alignment pin

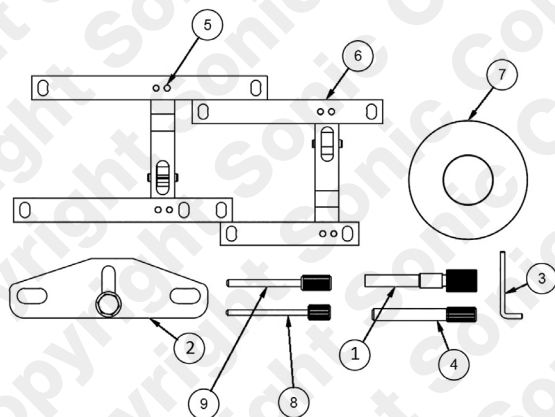

## Instructions

The following instructions are for guidance only. Please refer to OEM derived data such as the vehicles manufactures own data or Autodata. The use of these engine timing tools is purely down to the user's discretion and Sonic cannot be held responsible for any damage caused what so ever.

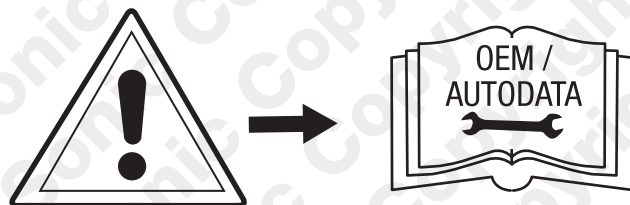

## Instructions

- Always refer to manufacturer specific data and instructions
- Turn engine to TDC No.1 cylinder before disassembly of engine

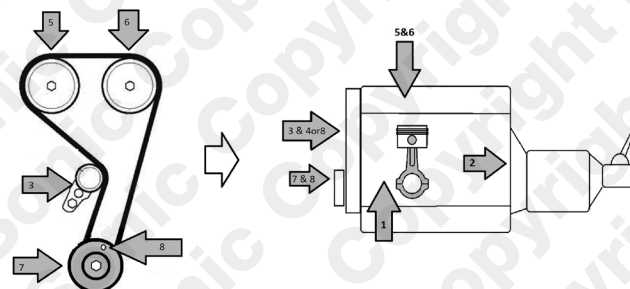

### Crankshaft Alignment Pin 1

Component (1) is used to lock the crankshaft in it timed position. NB: do not attempt to torque any fixing against component 1. Use component 2 for tightening or loosening the crankshaft pulley.

### ENGINE BLOCK

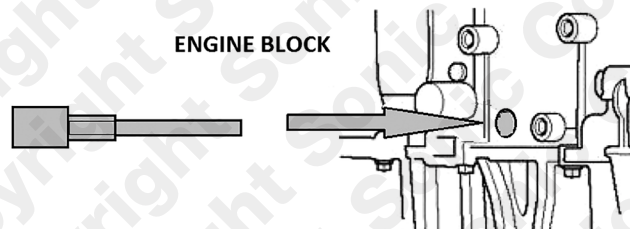

### Flywheel Holding Tool 2

Component (2) is used to lock the flywheel when loosening and tightening the crankshaft pulley bolt. Remove the starter motor and fit (2) into the starter aperture.

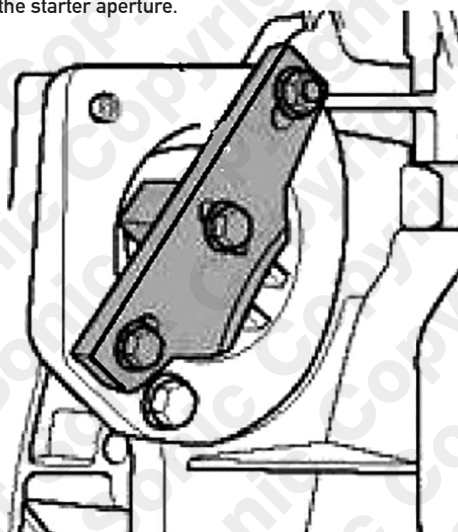

WWW.SONIC-EQUIPMENT.COM

### Auxiliary Belt Tensioner Pins 4 & 8

Components 4 & 8 are used to lock the auxiliary belt tensioner in their retracted positions. Component 4 is used on the EcoSport models only.

### Cambelt Tensioner Locking Pin 3

Tensioner pin (3) is used to lock the belt tensioner in its fully retracted position

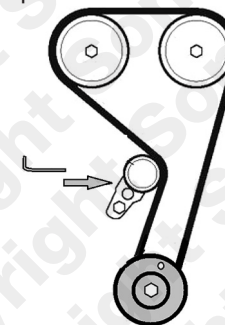

### CRANKSHAFT PULLEY ALIGNMENT PIN 9

Component 9 is used to initially set the position of the crankshaft via a hole in the front pulley.

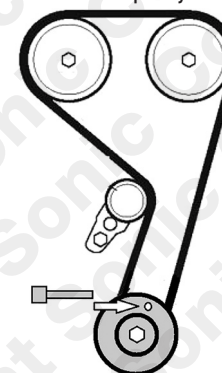

### Camshaft Locking Tools 5 & 6

Camshaft locking tools (5 & 6) are used to lock the camshafts in their timed positions independently of their pulleys. With component (1) in position and the engine set at TDC number 1 cylinder fir components 5 & 6 then tighten the locking bolts (1) finger tight.

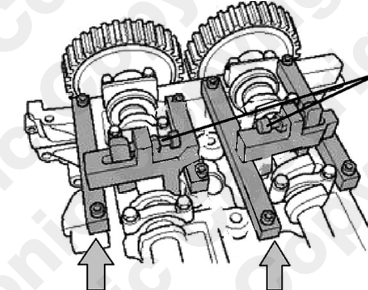

### Crankshaft Pulley Oil Seal Fitting Tool 7

Component 7 is used to fit the new crankshaft oil seal into the front cover after the cover has been fitted to the engine.

