

Oil Filter Wrench for Land Rover

Art. Nr: PT55058

Contents

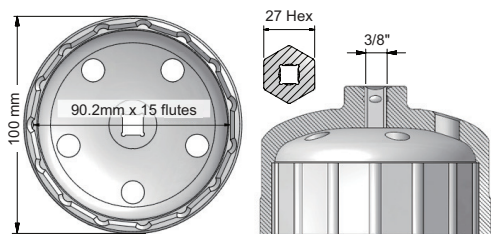

Dimension	15 flutes x 90.2mm
Height	66mm
Square Drive	3/8"DR
Material	Aluminum
Surface Finish	Chrome
Torque	25 ± 5 Nm



Instructions

**CAUTION**

- Always read the instructions carefully before using the tool
- DO NOT use an air/impact wrench to work with the tool
- Ensure the working area has adequate lighting
- Keep children and unauthorized persons away from the working area
- Keep working area clean and tidy, dry and free from unrelated materials
- DO NOT allow untrained persons to use this tool kit
- Always wear eye protection that meets OSHA and ANSI Z87.1 standards
- Always wear gloves when working with the tool
- Always wear ear protection
- Disposal: Customers should follow local regulations to handle used/wasted parts

Removing an old filter cartridge

Use a 27mm hex socket to connect a ratchet wrench and oil filter wrench, and turn counterclockwise for removal.

Installing a new filter cartridge

Use a 3/8"DR ratchet wrench and connect to oil filter wrench for installation. Apply some oil on oil filter cover rim before installation.

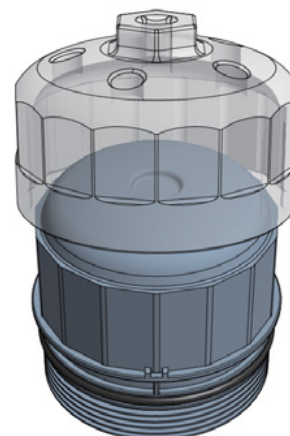

Applications

Make	Model	Year	Make	Model	Year
Land Rover	Discovery	2017-2017	Land Rover	Range Rover - Base 3.0L V6 – Diesel	2016-2016
Land Rover	LR 4 - Base 3.0L V6 – Gasoline	2014-2016	Land Rover	Range Rover - Base 5.0L V8 – Gas	2013-2016
Land Rover	LR 4 - Base 5.0L V8 – Gasoline	2011-2015	Land Rover	Range Rover - HSE 3.0L V6 – Gas	2014-2016
Land Rover	LR 4 - HSE 3.0L V6 – Gasoline	2014-2015	Land Rover	Range Rover - HSE 5.0L V8 – Gas	2010-2013
Land Rover	LR 4 - HSE Lux 3.0L V6 – Gasoline	2011-2013	Land Rover	Range Rover - Superchg 5.0L V8 – Gas	2010-2017
Land Rover	LR 4 - HSE Lux 5.0L V8 – Gasoline	2014-2016	Land Rover	Range Rover Sport - Atbg. 5.0L V8 – Gas	2015-2017
Land Rover	LR 4 - Base 5.0L V8 – Gasoline	2013-2015	Land Rover	Range Rover Sport - HSE 3.0L V6 – Gas	2015-2017
Land Rover	Range Rover - Atbg. 5.0L V8 – Gas	2013-2016	Land Rover	Range Rover Sport - HSE 5.0L V8 – Gas	2010-2017
Land Rover	Range Rover - Base 3.0L V6 – Gas	2014-2016	Land Rover	Range Rover Sport - SE 3.0L V6 – Gas	2014-2017