

Pro**Meister**



Refer to Instruction  
Manual



Wear Protective  
Gloves



Wear Eye  
Protection

# User Guide

## 12V Brake Bleeder

Art. Nr: PT5111

Produced in Taiwan for Bileko

**Bileko**

P.O. Box 542

S-645 25 Strängnäs, Sweden

Tel: +46 771 72 00 00

[www.promeister.com](http://www.promeister.com)

RVNR-02

## Specifications

Powered by the vehicle's 12V battery. Designed for bleeding of the vehicle's brake or clutch system. Bleed pressure is closely controlled up to 2.5bar – suitable for most vehicles. Compatible with ABS system, DOT3, DOT4 and DOT5.1. Auto-shut-off device to prevent the system running dry.

Power Supply .....	12V
Fluid Pump .....	Diaphragm Pump
Maximum Pressure .....	2.5 bar
Tank Capacity .....	5 ltr
Main Body .....	Stainless Steel

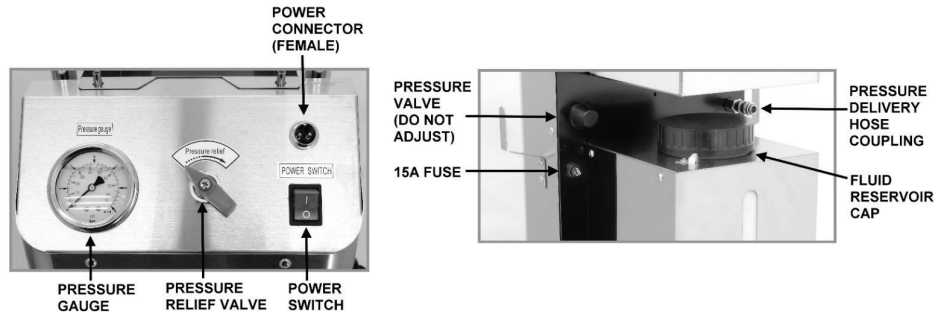

## Accessories

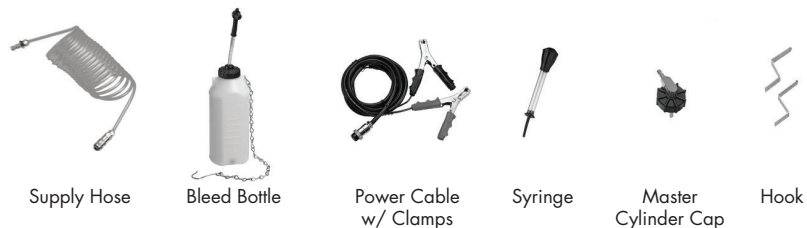

## Caution Before Operating

1. ONLY use PT5111 for bleeding brake circuits or hydraulic clutches.
2. DO NOT cross-connect the unit to battery. Ensure positive/RED clamp is to positive terminal and negative/BLACK clamp is to negative terminal.
3. DO NOT disconnect master cylinder cap from PT5111 until the unit has been fully de-pressurised. After each service, the unit must be de-pressurised by rotating the **pressure relief valve** on the unit clockwise.
4. DO NOT touch the vehicle's pedal while bleeding the brakes

## Filling Procedure

**SAFETY CAUTION: ALWAYS ENSURE THAT THE PRESSURE RELIEF VALVE IS OPEN BEFORE USE. THIS BLEEDER OPERATES UNDER PRESSURE. IT IS THEREFORE VERY IMPORTANT NOT TO COMMENCE ANY WORK WITHOUT ENSURING THAT THERE IS NO PRESSURE LEFT IN THE UNIT.**

1. Remove the **fluid reservoir cap** on the unit, and fill the unit with new brake fluid.
2. **Power switch** must be off at this moment.
3. To fill in just enough fluid for each service is recommended to prevent contamination from the air.
4. Tighten the cap and ensure that there is a good seal.

## Purge The Air From The Device Line

Each time the bleeder is filled with new brake fluid, air must be purged from the fluid supply hose before connecting to the vehicle.

1. Attach the supply hose to the pressure delivery hose coupling on the back of the unit.
2. Attach the master cylinder cap to the quick connector on the supply hose.
3. Hold over an extra container (to collect any brake fluid that is forced out)
4. Connect the unit to battery.
5. Press "ON" on the power switch.
6. When the fluid reaches the quick connector of the supply hose, push "OFF" on the power switch.

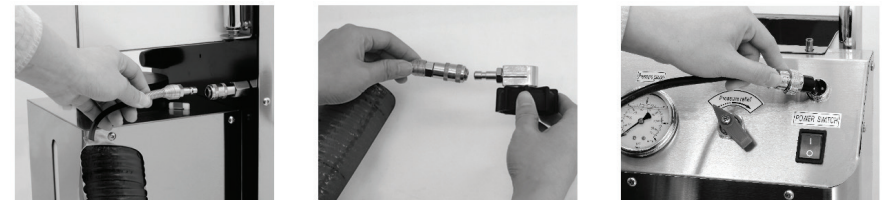

## Brake Bleeding Procedure

**CAUTION: Each time the bleeder is filled with new brake fluid, air must be purged from the fluid supply hose before connecting to the vehicle.**

1. Attach the **supply hose** to the pressure delivery hose coupling on the unit. Plug the **master cylinder cap** into the quick connector on the **supply hose**. Screw the **master cylinder cap** on the reservoir of the vehicle's brake system.
2. Connect PT5111 to the battery.
3. Open brake nipple and connect it to the **bleed bottle**.
4. Rotate the **pressure relief valve** on the unit clockwise and turn on the **power** to start brake fluid change. Adjust the pressure by rotating the **pressure relief valve** on the unit anti-clockwise to accommodate the requirement of different vehicles. ( The unit can reach max 2.5 bars )
5. Once seeing new fluid coming into the **bleed bottle**, turn off the **power**. The excess fluid will be returned back to the new fluid reservoir on the unit. Apply the process to all 4 wheels in any order.
6. Once the process is complete, turn off the **power** and rotate the **pressure relief valve** clockwise to **release the pressure in the unit**. Disconnect the **supply hose** from the **master cylinder cap**. Take **master cylinder cap** off the reservoir in the vehicle.
7. Dispose the waste brake fluid safely.