

Applications

Make	Model	Year	Type
Ford	B-MAX	2012-2017	EcoBoost Zetec S Red Black edition SCTi EcoBoost ECUnetic
	C-MAX	2012-2017	
	EcoSport	2013-2017	
	Fiesta	2013-2017	
	Focus	2012-2017	
	Grand C-MAX	2012-2017	
	Grand Tourneo Connect	2013-2017	
	Mondeo	2015-2017	
	Tourneo Connect	2013-2017	
	Transit Connect	2013-2017	
	Transit Courier	2014-2017	

Engine Code

1.0	M1CA, M1CB, M1DA, M1DD, M1JA, M1JC, M1JE, M1JH, M1JJ, M2DA, M2DB, M2DC, M2GA, M2GB, P4JA, P4JB, P4JC, P4JD, SFCA, SFCB, SFCC, SFCD, SFDB, SFJA, SFJB, SFJC, SFJD, XMJA, XMJB, XMJC, XMJD, YYJA, YYJB
-----	--

Our products are designed to be used correctly and with care for the purpose for which they are intended. No liability is accepted by Sonic for incorrect use of any of our products, and Sonic cannot be held responsible for any damage to personnel, property or equipment when using the tools. Incorrect use will also invalidate the warranty.

If applicable, the applications database and any instructional information provided has been designed to offer general guidance for a particular tool's use and while all attention is given to the accuracy of the data no project should be attempted without referring first to the manufacturer's technical documentation (workshop or instruction manual) or the use of a recognised authority such as Autodata.

It is our policy to continually improve our products and thus we reserve the right to alter specifications and components without prior notice. It is the responsibility of the user to ensure the suitability of the tools and information prior to their use.

ART NO. 829135

sonic
equipment

Instructions

Cambelt Timing Kit Ford 1.0GTDI



829135 - Cambelt Timing Kit

Developed to lock the engines of the vehicles listed in their "timed" position so that the cambelt can be safely removed and replaced.

Please note: where the VCT pulleys require removing or setting an additional kit will also be required.

Components

Ref	Comp	OEM	Description
1	4880254	303-1602	Flywheel Locking Tool
2	4880253	303-1604	Crankshaft Timing Pin
3	4880274	303-1054	Tensioner Pulley Locking Pin
4	4880096	303-732	Crankshaft Pulley Locking Pin
5	4880367	Equivalent to 303-1605/2	Camshaft Setting Block Exhaust
6	4880366	Equivalent to 303-1605/1	Camshaft Locking Block Inlet
7	4880238	303-1603	Oil Seal Installer
8	4880090	8mm Pin	Tensioner Pin (Ecosport only)
9	4880121	4mm Pin	Tensioner Pin (Not For Ecosport only)
10	4880216		Bolts for 5&6 (M6X30 Cap Head Screw)

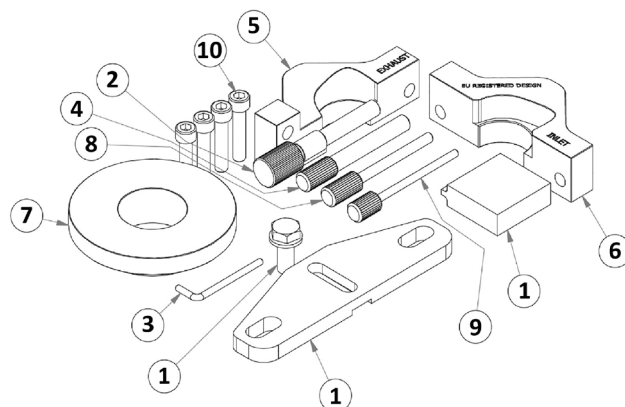

The following instructions are for guidance only. Please refer to OEM derived data such as the vehicles manufacturers own data or Autodata. The use of these engine timing tools is purely down to the user's discretion and Sonic cannot be held responsible for any damage caused whatsoever.

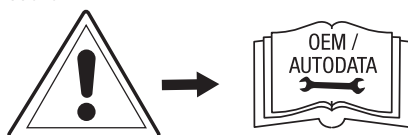

Always refer to manufacturer specific data and instructions. The camshaft drive belt on the EcoBoost 1.0L engine is "oil bathed". The front engine casing must be removed to gain access. Turn engine to TDC number one before disassembly of engine. Remove starter motor and use component A to hold the flywheel when undoing the crankshaft pulley bolt.

Instructions

Component 1

Flywheel Locking Tool

Remove the starter motor, assemble component (1) and fit in the starter aperture so that its tooth locks the flywheel.

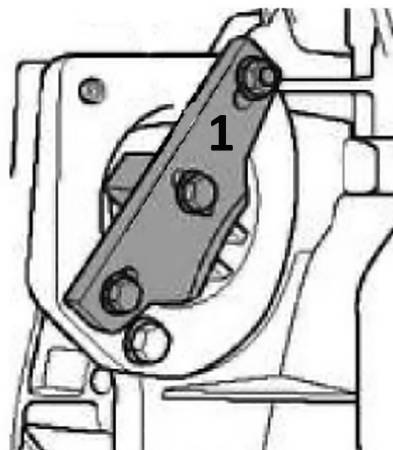

Component 2

Crankshaft Timing Pin

Remove the blanking plug in the side of the engine block and fit component (2). Turn the crankshaft slowly clockwise until the crankshaft web contacts the end of component (2).

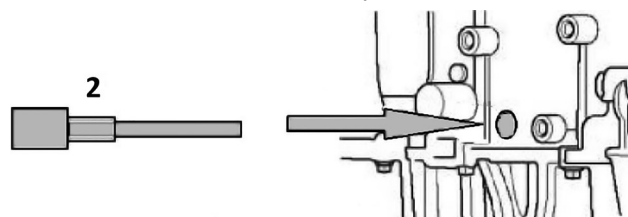

Component 3

Tensioner Pulley Locking Pin

Used to lock the belt tensioner in its fully retracted position.

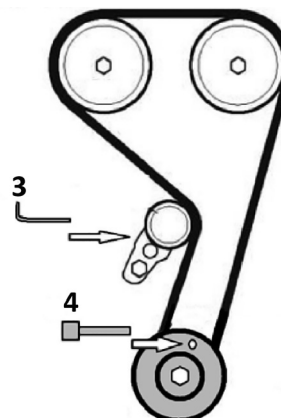

Component 4

Crankshaft Pulley Locking Pin

Used to initially set the position of the crankshaft via a hole in the front crankshaft pulley.

WWW.SONIC-EQUIPMENT.COM

Component 5 & 6

Camshaft Setting Block Exhaust & Camshaft Locking Block Inlet
Used to lock the camshafts in their timed position independently of their pulleys.

With component (2) already fitted and the engine at TDC No.1 cylinder. Fit the components 5 and 6 ensuring they seat on the surface of the cylinder head.

Fit fixing bolts hand tighten (use the cam cover bolts for this purpose).

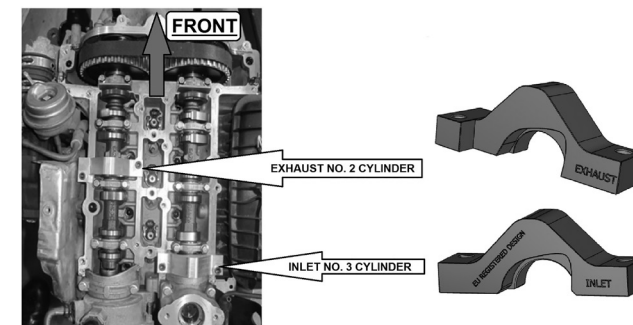

Component 7

Oil Seal Installer

Used to fit the new front crankshaft oil seal into the front cover after the front cover has been fitted to the engine.

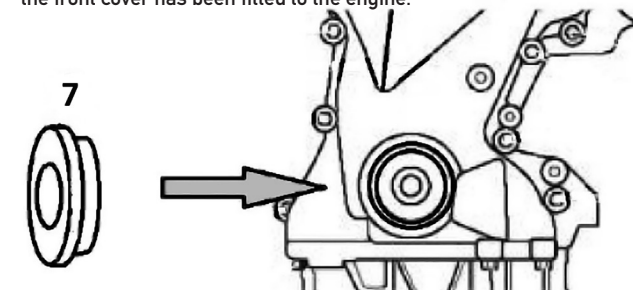

N.B. Observe manufacturers tightening sequence and torques for the front cover bolts.