

## Applications

Make	Model	Year	Type
Opel/Vauxhall	Antara	From 2016	CDTi CDTi EcoFLEX CDTi/Blueinjection
	Cascada	From 2015	
	Insignia-A	2014-2017	
	Insignia-A Country Tourer	2014-2017	
	Insignia-B	From 2017	
	Insignia-B Country Tourer	From 2017	
	Zafira-C Tourer	From 2017	

## Engine Code

2.0	LFS/B20DTH, LFS/B20DTR
-----	------------------------

Our products are designed to be used correctly and with care for the purpose for which they are intended. No liability is accepted by Sonic for incorrect use of any of our products, and Sonic cannot be held responsible for any damage to personnel, property or equipment when using the tools. Incorrect use will also invalidate the warranty.

If applicable, the applications database and any instructional information provided has been designed to offer general guidance for a particular tool's use and while all attention is given to the accuracy of the data no project should be attempted without referring first to the manufacturer's technical documentation (workshop or instruction manual) or the use of a recognised authority such as Autodata.

It is our policy to continually improve our products and thus we reserve the right to alter specifications and components without prior notice. It is the responsibility of the user to ensure the suitability of the tools and information prior to their use.

ART NO. 829127

**sonic**  
equipment

## Instructions

### Engine Timing Tool Kit Vauxhall/Opel 2.0 CDTi



## 829127 - Engine Timing Tool Kit

This kit has been developed to lock the main engine components on the latest Vauxhall/Opel CDTi 2.0L engines from 2014 onwards, to allow removal and replacement of the camshaft drive belt. The kit also contains the tool required to lock the flywheel on vehicles fitted with automatic transmission.

N.B: for replacement of the camshaft drive chain in the cylinder head additional tooling will be required – 829128.

### Components

Ref	Comp	OEM	Description
1	4880394	EN-51413	High-pressure fuel pump sprocket locking tool (locking tool only)
2	4880121	EN-955-2	Auxiliary drive belt tensioner tool
3	4880397	EN-51412	Crankshaft timing tool (3 parts)
4	4880396	EN-51414	Camshaft Locking pin
5	4880398	EN-51411	Crankshaft holding tool (Via ring gear automatic transmission)
	4880353		M8 x 30 Cap Head
	4880354	EN-51412	Locking Pin 6.35 x 50mm

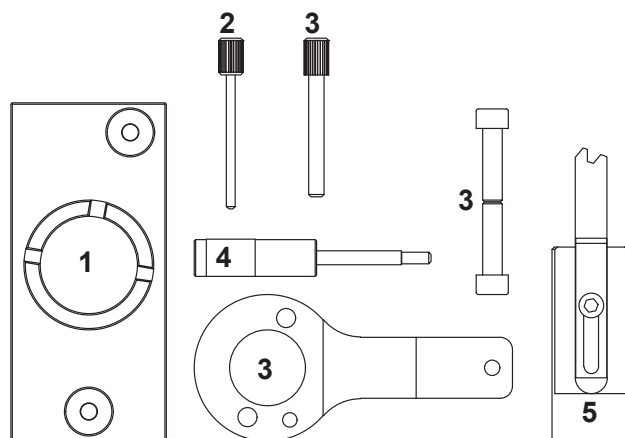

The following instructions are for guidance only. Please refer to OEM derived data such as the vehicles manufacturers own data or Autodata. The use of these engine timing tools is purely down to the user's discretion and Sonic cannot be held responsible for any damage caused whatsoever.

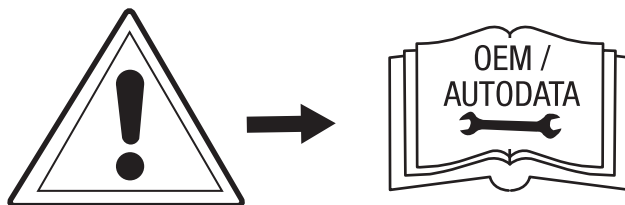

### Instructions

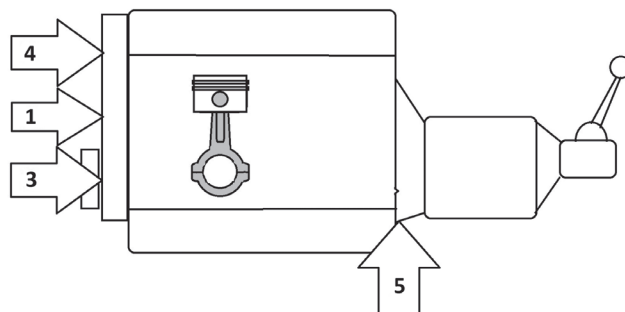

Component 1 = High-pressure fuel pump sprocket locking tool (locking tool only)  
Used to lock the fuel pump sprocket in its timed position.

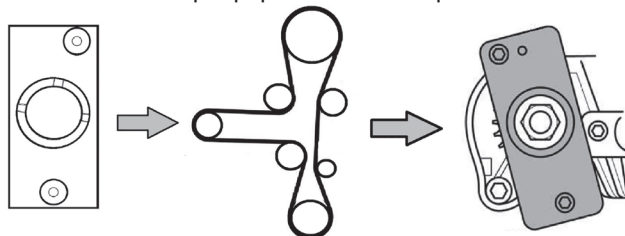

Component 2 = Auxiliary drive belt tensioner tool  
Used to lock the auxiliary drive belt tensioner in it fully retracted position.

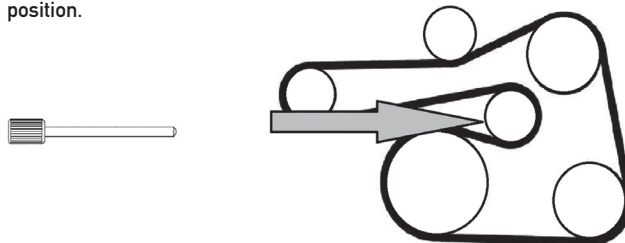

Components 3 = Crankshaft timing tool (3 parts)  
Used to align and lock the crankshaft in its timed position.

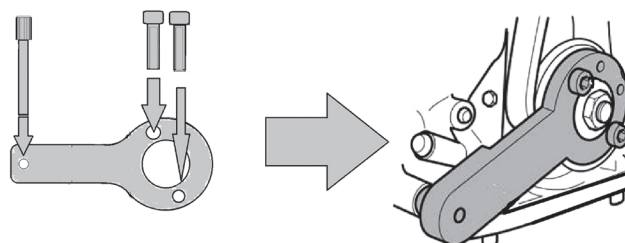

Component 4 = Camshaft Locking pin  
Used to lock the camshaft pulley in its timed position.

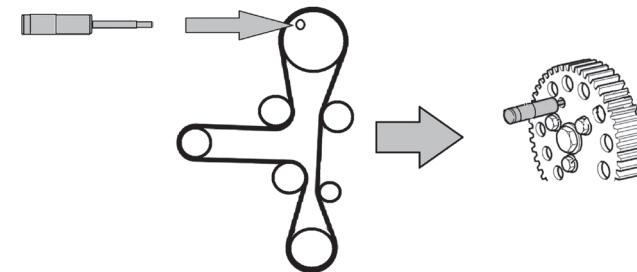

Component 5 = Crankshaft holding tool (automatic transmission)  
Used to lock and hold the flywheel from underneath the car to allow the crankshaft pulley bolt to be loosened and tightened.

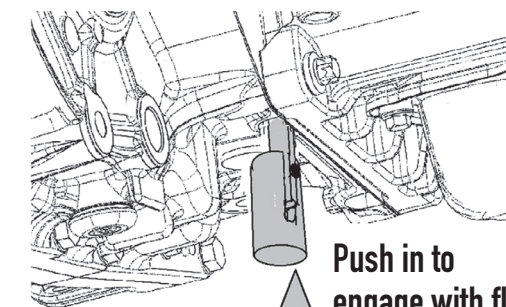
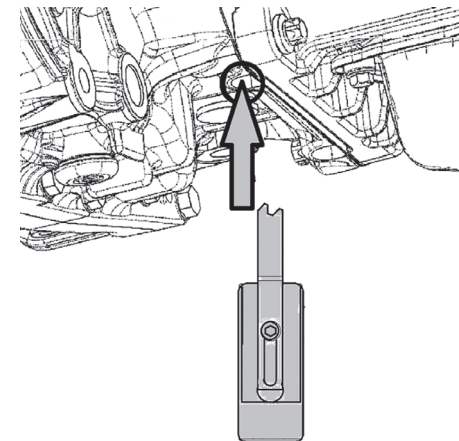

Push in to engage with flywheel and tighten bolt.